

4 | 3 | 2 | 1

THIS DRAWING AND THE INFORMATION CONTAINED HEREIN IS THE PROPERTY OF MEASUREMENT SPECIALTIES, INC. AND SHALL NOT BE USED, REPRODUCED, PUBLISHED OR DISCLOSED TO OTHERS WITHOUT THE EXPRESS WRITTEN CONSENT OF MEASUREMENT SPECIALTIES, INC.

REVISIONS				
REV	DESCRIPTION	REL	DATE	APPROVED
A	INITIAL RELEASE.	J.Z.	12-17-12	

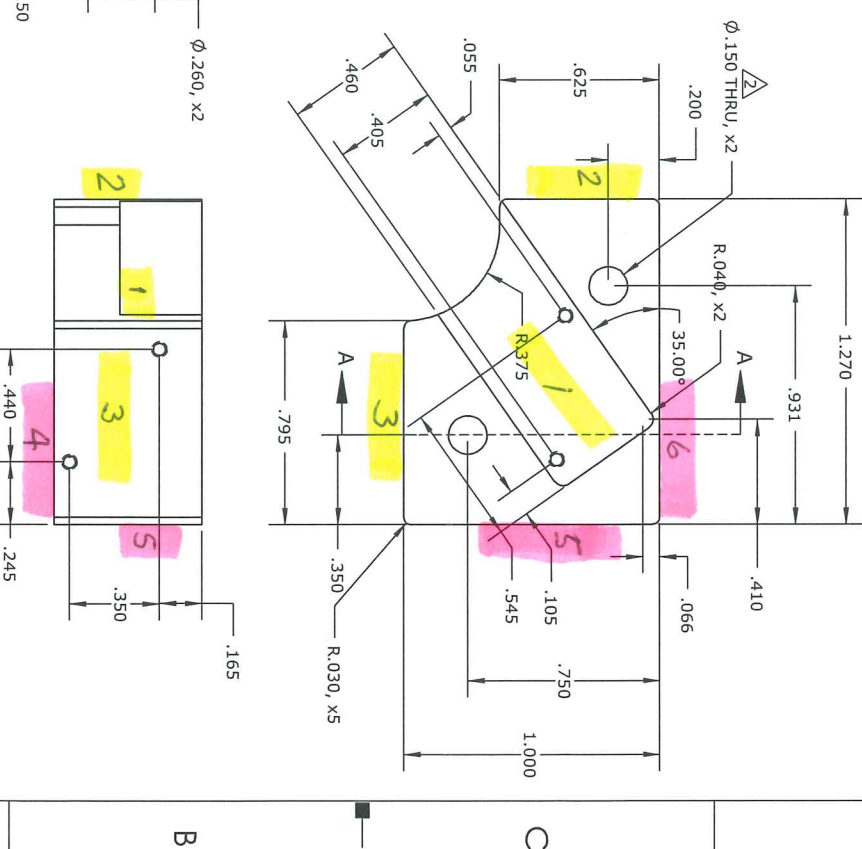
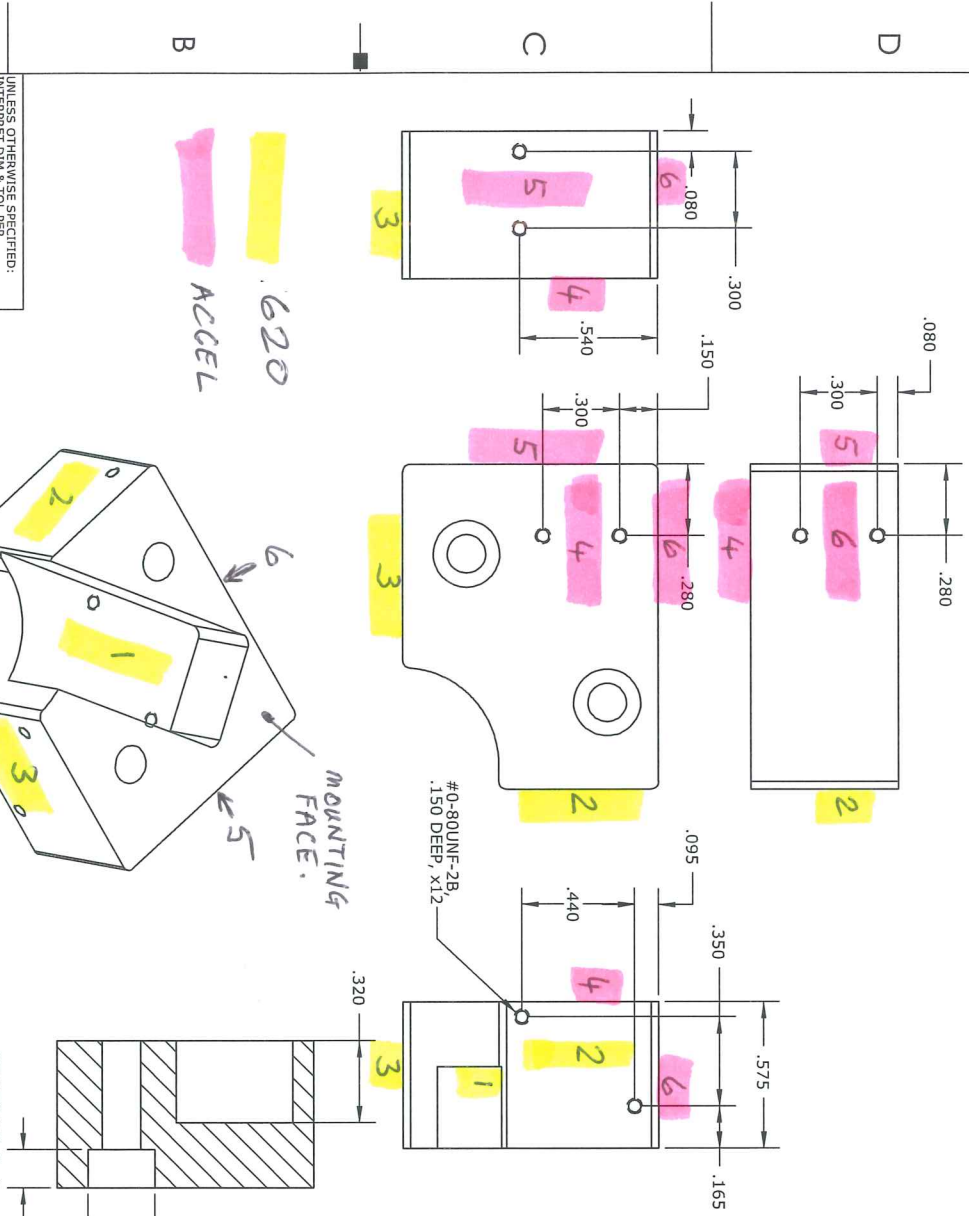

UNLESS OTHERWISE SPECIFIED:
 INTERPRET DIM. & TOL. PER
 ASME Y14.5M-2009 UNLESS
 OTHERWISE NOTED.
 DIMENSIONS ARE IN INCHES
 UNLESS OTHERWISE NOTED.
 REMOVE BURRS.
 COUNTERSINK INTERNAL THDS
 TO FULL DEPTH.
 CHAM. EXT THDS 45° TO MINOR DIA.
 THD LENGTHS AND DEPTHS ARE FOR
 FIN. OPER. UNLS.
 DIMENSIONS APPLY AFTER FINISHING
 OPERATIONS.
 63 ✓ ALL MACHINED SURFACES.
 MACHINED FILLET RADI .005 TO .010.
 BREAK SHARP EDGES .005 TO .015.
 FINISH SYMBOLS PER AMS A2.4.
 ABRASIVATIONS PER MIL STD 12.

NOTES:
 1. Hard anodize per MIL-A-8625, Type III, Class 2, .0008/.0015 thick. Dyed black.
 2. Hold marks for anodize permissible on the $\phi .150$ holes.
 3. All dimensions apply after anodizing.

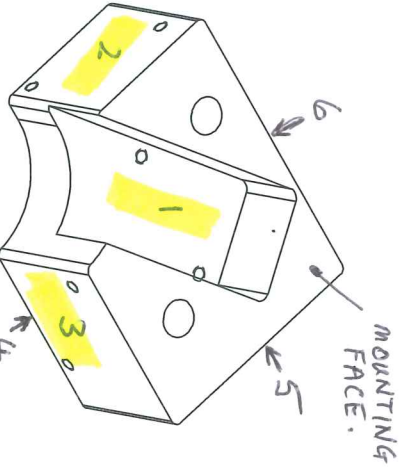

HOLE DIA.	TOLERANCE
1.125 THRU 1.500	+0.007/-0.003
1.500 THRU 2.000	+0.007/-0.003
2.000 THRU 2.500	+0.007/-0.003
2.500 THRU 3.000	+0.007/-0.003
3.000 THRU 4.000	+0.007/-0.003
4.000 THRU 5.000	+0.007/-0.003
5.000 THRU 7.000	+0.007/-0.003
7.000 THRU 10.000	+0.007/-0.003
10.000 THRU 20.000	+0.007/-0.003
20.000 THRU 40.000	+0.007/-0.003
40.000 THRU 100.000	+0.007/-0.003
100.000 THRU 200.000	+0.007/-0.003
200.000 THRU 500.000	+0.007/-0.003
500.000 THRU 1000.000	+0.007/-0.003

MODEL 620/621
 USED ON NEXT ASSY

THIRD ANGLE PROJECTION		TOLERANCES	
		UNLESS OTHERWISE SPECIFIED, DIMENSIONS AND TOLERANCES ARE IN INCHES AND SHALL BE INTERPRETED PER ANSI Y14.5M-1994. TOLERANCES ARE AS FOLLOWS: FRACTIONS DECIMALS ANGLES ± .XX ±.001 ±°	MATERIAL: AL6061-T6
DRAWN	Jeff. Zhao	DATE	8-15-12
CHECKED		TITLE: 6-AXIS MOUNTING BLOCK 620	
APPROVED		SCALE	6:1
SIZE CAGE NO.		DWG NO. (AC-D04311)	
REV A		SHEET 1 OF 1	

4 | 3 | 2 | 1