



69XX

Wireless Pressure Transducer With LoRaWAN

SPECIFICATIONS

- 316L Stainless Steel Wetted Surface
- LoRaWAN Class A Wireless Connection
- Digital 24-bit ADC Output
- Weatherproof (IP66/IP67)
- CE Certified
- ATEX Certified
- Variety of Pressure Ports

The 69XX wireless pressure transducer is enclosed in a stainless steel and PET+15%GF housing. This high accuracy wireless transducer eliminates hard wiring and provides remote process monitoring via LoRaWAN wireless communication. This series is suitable for measurement of liquid or gas pressure, even for difficult media such as contaminated water and mildly corrosive fluids.

The Intrinsically Safe 69XX is certified to:

Class I, Division 1 Groups A, B, C, D, T4

Class I Zone 0, AEx ia IIC T4 Ga

Ex ia IIC T4 Ga

Ta / Process Temp: -30 °C to +75 °C

The wetted material of the pressure port is 316L stainless steel and the transducer's durability is excellent with no O-rings or organics exposed to the pressure media. The 69XX is weatherproof and exceeds the latest heavy industrial CE requirements.

FEATURES

- Accuracy as high as $\pm 0.1\%$ FS
- Total Error Band down to $\pm 1\%$ FS
- Integrated sensor temperature output typical accuracy as $\pm 5^\circ\text{C}$
- Available LoRaWAN frequencies: 868MHz (EU) /915MHz (USA)
- Wide operating Temperature range as -30°C to 75°C
- Rugged Construction can withstand 50g Shock/8g Vibration
- 10 V/m EMI Protection
- Excellent stability can withstand 1M 0~FS pressure cycles @ 25°C

APPLICATIONS

- Process Controls
- Tank Level Measurement
- Filter Performance Monitoring
- Corrosive Fluids and Gas Measurement Systems
- Flow Measurements

69XX

Wireless Pressure Transducer With LoRaWAN

STANDARD RANGES

Pressure range (Bar)	Absolute
0 to 7	•
0 to 20	•
0 to 35	•
0 to 350	•

PERFORMANCE SPECIFICATIONS

Ambient Temperature: 25°C (unless otherwise specified)

PARAMETERS	MIN	TYP	MAX	UNITS	NOTES
Supply Voltage	2.8	3	3.6	V _{DC}	Replaceable LS17330 battery
Accuracy	7, 20, 35 bar: ±0.1% 350 bar: ±0.25%		0.1 0.25	%Span	1
Resolution		24		Bit	
Pressure Cycles	1.00E+06			0-FS Cycles	
Proof Pressure			3X	Rated	
Burst Pressure			4X	Rated	
Long Term Stability		±0.1		%Span/year	
Total Error Band	-1		1	%Span	
Compensated Temperature	-30		70	°C	
Operating Temperature	-30		75	°C	With battery
Storage Temperature	-40		80	°C	Without battery
Wireless Protocol	LoRaWAN Class A				
Signal Transmission Distance	2 KM TBD				
Battery Life	2.5-year TBD				
Weatherproof	IP66 & IP67				
Sensor Type	Oil filled capsule				
Pressure Port Material	316L Stainless Steel				
Shock	50g, 11 msec Half sine shock per MIL-STD-202F, Method 213B, Condition A				
Vibration	Max 8g, 7Hz-200Hz, IEC 62133-2:2017				

Notes

1. RSS combined linearity, hysteresis and repeatability.
2. Battery life depends on its capacity, operating temperature and signal transmission interval.
3. Temperature can impact battery capacity retention even in idle. Check battery specifications for more details.
4. Factory default data transmission rate is 10-30min, The specific time period depends on

69XX

Wireless Pressure Transducer With LoRaWAN

Compliances

ATEX, IECEx, US/CAN

ISED

RoHS

FCC

RED

Bluetooth®

LoraWAN

Pressure Port Options

2 = 1/4-19 BSPP Male

5 = 1/4-18 NPT Male

DIMENSIONS

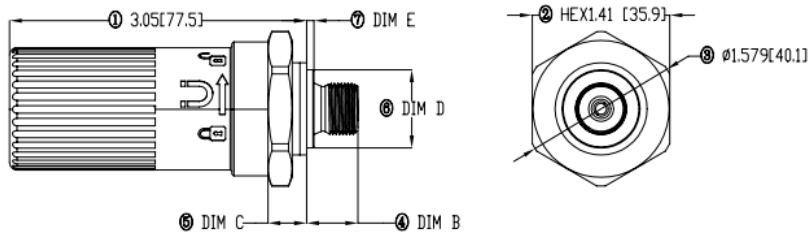

PORT TYPE	PRESSURE RANGE	DIM B TYP.	DIM C TYP.	DIM D TYP.	DIM E TYP.
1/4-18 NPT	7 BAR	0.60 [15.24]	0.397 [10.08]	NA	NA
	20 BAR				
	35 BAR				
	350 BAR				
1/4-19 BSPP	20 BAR	0.526 [13.36]		0.80 [20.32]	0.075 [1.905]
	350 BAR				

ORDERING INFORMATION

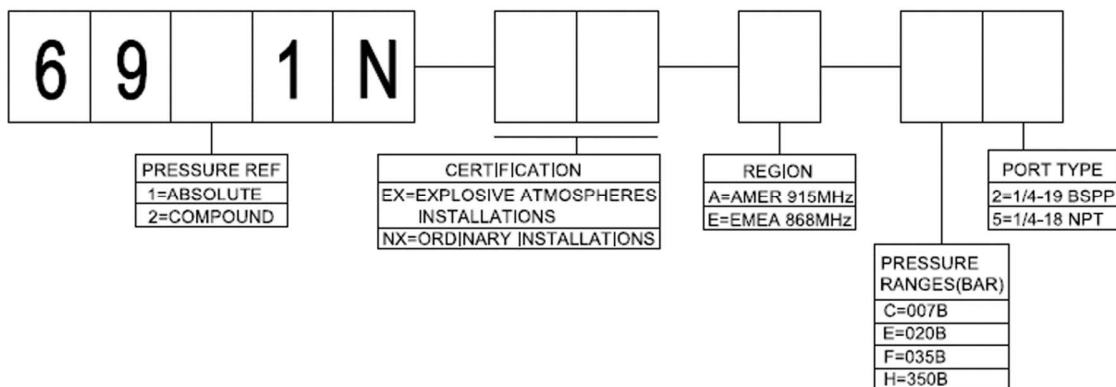

69XX

Wireless Pressure Transducer With LoRaWAN

NORTH AMERICA

Measurement Specialties, Inc.,
a TE Connectivity Company
Phone: 800-522-6752
Email: customercare.fmt@te.com

EUROPE

Measurement Specialties (Europe), Ltd.,
a TE Connectivity Company
Phone: +31 73 624 6999
Email: customercare.lcsb@te.com

ASIA

Measurement Specialties (China), Ltd.,
a TE Connectivity Company
Phone: 0400-820-6015
Email: customercare.shzn@te.com

TE.com/sensors

Measurement Specialties, Inc., a TE Connectivity company.

Measurement Specialties, TE Connectivity, TE Connectivity (logo) and EVERY CONNECTION COUNTS are trademarks. All other logos, products and/or company names referred to herein might be trademarks of their respective owners.

The information given herein, including drawings, illustrations and schematics which are intended for illustration purposes only, is believed to be reliable. However, TE Connectivity makes no warranties as to its accuracy or completeness and disclaims any liability in connection with its use. TE Connectivity's obligations shall only be as set forth in TE Connectivity's Standard Terms and Conditions of Sale for this product and in no case will TE Connectivity be liable for any incidental, indirect or consequential damages arising out of the sale, resale, use or misuse of the product. Users of TE Connectivity products should make their own evaluation to determine the suitability of each such product for the specific application.

© 2015 TE Connectivity Ltd. family of companies All Rights Reserved.